

# S1

## Suspended LED Luminaire

For Ambient Lighting



Project: \_\_\_\_\_  
 Cat#: \_\_\_\_\_  
 Type: \_\_\_\_\_  
 Notes: \_\_\_\_\_

### Product Description

The S1 direct/indirect or direct only Architectural LED pendant offers modern industrial styling with regressed ends and cantilevered mounting for general lighting applications. Available in unique raw metal or powder coat finishes. Optional Performance Batwing upper optics and Baffle/Louver or Performance Optic configurations for lower distribution.

### Construction

S Series products are constructed out of die formed steel and aluminum and finished with raw metal or powder coat finishes. Lenses are high light transmission UV stable acrylic. Mounting to grid or drywall ceiling via fully adjustable aircraft cables.

### Light Source

Light source comprised of mid power LEDs that are thermally engineered to ensure optimal efficacy's over 100 lumens per watt and 80+ CRI. Luminaire light output guaranteed to achieve a minimum of 70% luminaire output over 100,000 hours at typical 25 deg. C operating conditions. LED components and luminaires are compliant with IESNA LM80.

### Certification and Warranty

Luminaires carry a limited 5 year warranty and all luminaires are UL listed for indoor damp rated lighting applications.

### Performance

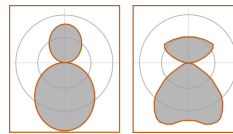

DD PP

Indirect/Direct	System Lumens (System Watts)			
	Optics Up/Down			
Lumens	DD	PD	DP	PP
750 lm/ft	3223lm (27.3w)	3232lm (27.3w)	3106lm (27.3w)	3115lm (27.3w)
1000 lm/ft	4074lm (34.9w)	4080lm (34.9w)	3926lm (34.9w)	3932lm (34.9w)
1350 lm/ft	5490lm (48.9w)	5523lm (48.9w)	5256lm (48.9w)	5289lm (48.9w)

Fixture Data for 3500K 4' Fixture. Lumens/Efficacy multiplier 0.97 for 3000K and 1.03 for 4000K. Test data may vary by +/- 5%.  
 See Page 3 for additional data

### Dimensions

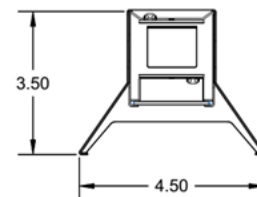

### Fixture Options

Example S140-D-D-37-1000F-35K-010-M-1C-A4-W-ST-GA

Series	S140 S180	42" Pendant 83" Pendant	S1__
Optics Up	N D P	No Optic (100% Down Light) Standard Diffuse Lens Performance Batwing Optic	
Optics Down	D P BB PB LS LB	Standard Diffuse Lens Performance Lens Black Baffle Performance Black Baffle Louvre Semi Specular Louvre Black	
Distribution	37 01	30%up / 70%dn 100% down	
Light Level	750F 1000F 1350F	750 lm per ft 1000lm per ft 1350lm per ft	
Color	30K 35K 40K T26	3000K 3500K 4000K Tunable White 2700K-6500K	
Driver	010 STD	0-10 volt Dimming STD Switched Driver	
Power	M	120-277 Universal	
Circuits	1C 2C	Single Circuit 2 Circuit Up/Down-82" Pendant Only	
Mounting	A4 A10	Aircraft Cable 4' Adjustable Aircraft Cable 10' Adjustable	
Mounting Color	W B	White Cords and Canopies (STD) Black Cords and Canopies	
Ceiling	G1 G9 GS ST	15/16" Grid Ceiling 9/16" Grid Ceiling Slot Grid Ceiling Drywall/Structure	
Finish	NA GA BA WH BK SM CC	Natural Aluminum Finish Galvanized Metal Finish Brushed Aluminum Finish White Powder Coat Finish Black powder Coat Finish Silver Metallic Powder Coat Custom Color Finish	
Options	EB	10 Watt Emergency Battery (S180 Only)	

# S1

## Suspended LED Luminaire For Ambient Lighting

### Fixture / Row Lengths

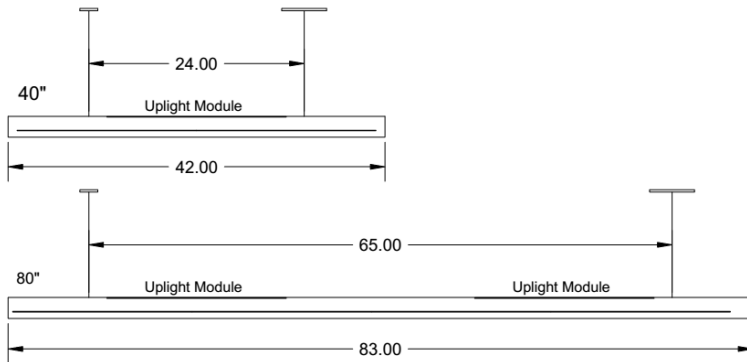

### Finish Options



### Mounting

#### ST- Drywall / Structure

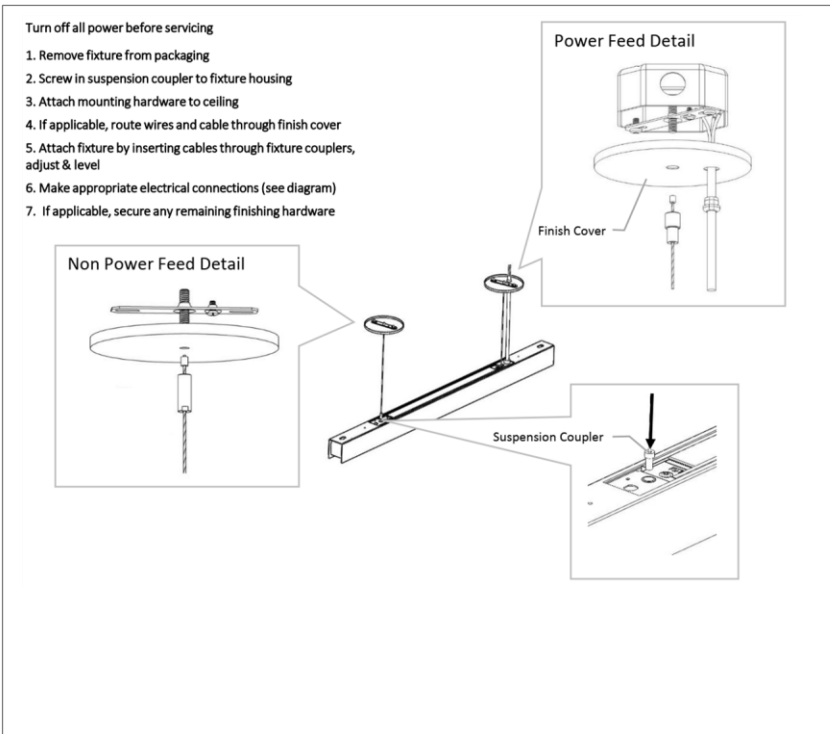

#### G1, G9, GS - Grid Ceiling

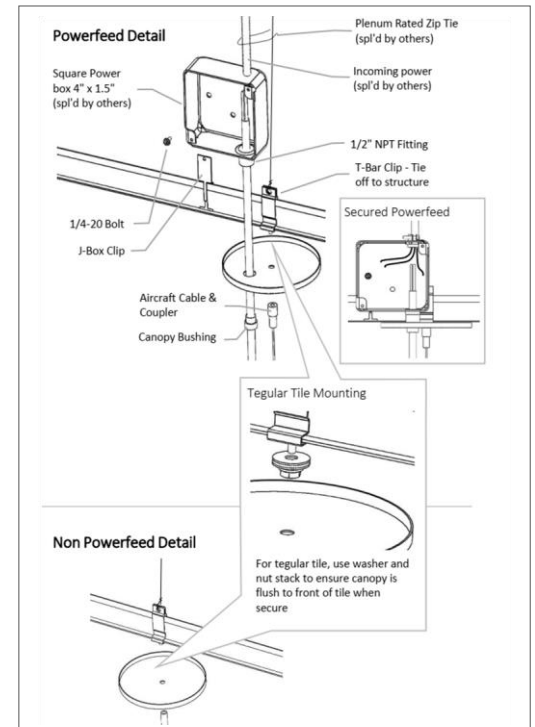

### Optics

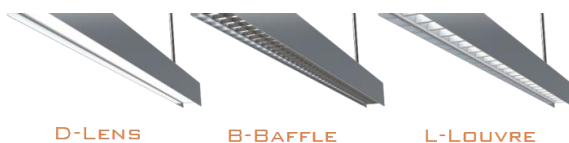

# S1

## Suspended LED Luminaire

For Ambient Lighting

### Performance

Fixture Data for 3500K 4' Fixture

Lumens/Efficacy multiplier 0.97 for 3000K and 1.03 for 4000K.

Test data may vary by +/- 5%

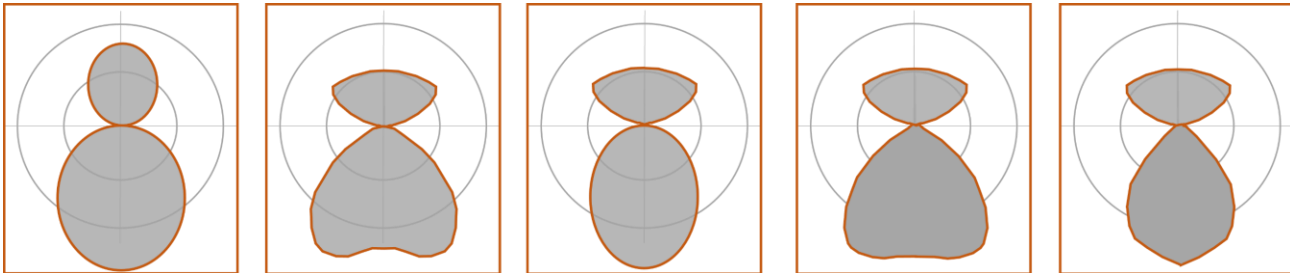

DD -Diffuse Up/Diffuse Down

PP-Performance up/Perform Dn

PBB-Performance Up/Baffle Dn

PPB-Perform Up/Perf Baffle Dn

PLS/LB-Perform Up/Louwer

Indirect/Direct	System Lumens (System Watts)											
	Optics Up/Down											
Lumens	DD	PD	DP	PP	DBB	DPB	DLS	DLB	PBB	PPB	PLS	PLB
750 lm/ft	3223lm (27.3w)	3232lm (27.3w)	3106lm (27.3w)	3115lm (27.3w)	2747lm (27.3w)	2529lm (27.3w)	2833lm (27.3w)	2557lm (27.3w)	2756lm (27.3w)	2538lm (27.3w)	2842lm (27.3w)	2567lm (27.3w)
1000 lm/ft	4074lm (34.9w)	4080lm (34.9w)	3926lm (34.9w)	3932lm (34.9w)	3472lm (34.9w)	3197lm (34.9w)	3581lm (34.9w)	3233lm (34.9w)	3479lm (34.9w)	3203lm (34.9w)	3587lm (34.9w)	3239lm (34.9w)
1350 lm/ft	5490lm (48.9w)	5523lm (48.9w)	5256lm (48.9w)	5289lm (48.9w)	4692lm (48.9w)	4317lm (48.9w)	4833lm (48.9w)	4317lm (48.9w)	4725lm (48.9w)	4350lm (48.9w)	4866lm (48.9w)	4350lm (48.9w)

Fixture Data for 3500K 4' Fixture. Lumens/Efficacy multiplier 0.97 for 3000K and 1.03 for 4000K. Test data may vary by +/- 5

Direct Only	System Lumens (System Watts)					
	Optics Down					
Lumens	D	P	BB	PB	LS	LB
750 lm/ft	3053lm (30.3w)	2873lm (30.3w)	2355lm (30.3w)	1987lm (30.3w)	2454lm (30.3w)	2037lm (30.3w)
1000 lm/ft	3974lm (38.6w)	3739lm (38.6w)	3065lm (38.6w)	2586lm (38.6w)	3194lm (38.6w)	2651lm (38.6w)
1350 lm/ft	5328lm (56.1w)	5013lm (56.1w)	4110lm (56.1w)	3468lm (56.1w)	4282lm (56.1w)	3555lm (56.1w)

Fixture Data for 3500K 4' Fixture. Lumens/Efficacy multiplier 0.97 for 3000K and 1.03 for 4000K. Test data may vary by +/- 5